



GLASS DOOR FITTINGS

System Overview7.3

Patch Fittings



Bottom Door	7.4	Sidelite/Transom Door	7.7
Top Door	7.5	Connector Patch Fitting	7.8-7.9
Transom Door	7.6		

Locks



Center Door Patch Lock	7.9	Center Door Patch Strike	7.10
Corner Door Patch Lock	7.10		

Rails



Bottom Door Rail	7.11	Top Door Patch Strike	7.12
Wall and Ceiling Clamping Profile	7.11	Top Door Rail	7.12

System Overview

Double door design

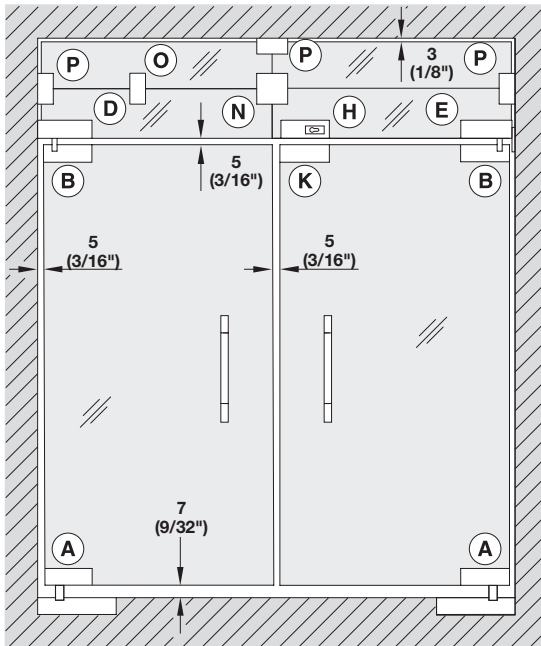

Single door design

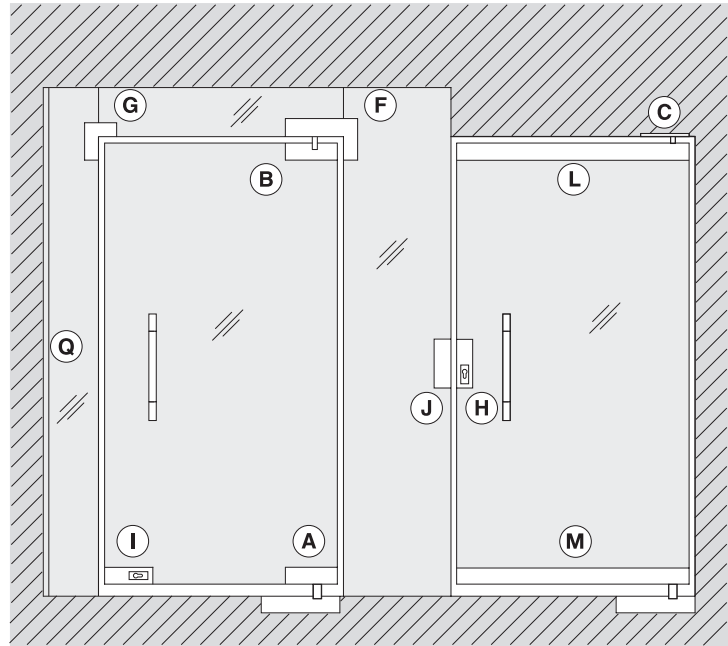

- A Bottom door patch fitting
- B Top door patch fitting
- C Top pivot, surface mounted
- D Transom door patch fitting with pivot, with threaded bolt for wall mounting
- E Transom door patch fitting with pivot, with mounting plate for wall mounting
- F Sidelite/transom door patch fitting with pivot
- G Sidelite/transom connection patch fitting
- H Center door patch lock, prepared for Euro profile cylinder
- I Corner door patch lock, prepared for Euro profile cylinder
- J Center door patch strike
- K Top door patch strike for center door patch lock
- L Top door rail
- M Bottom door rail
- N Connector patch fitting for connecting corners of four glass panes
- O Connector patch fitting for connecting two glass panes
- P Connector patch fitting for wall or ceiling mounting
- Q Wall and ceiling clamping profile

Dimensional data not binding. We reserve the right to alter specifications without notice.

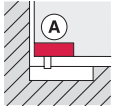

Bottom Door Patch Fitting [Ⓐ]

- For glass thickness: 10-12.7 mm (13/32"-1/2")
- With insert for flat conical floor mounted door closer spindle
- Load capacity: ≤ 80 kg (176 lbs.)
- Door width: ≤ 1.1 m (43 5/16")
- Concealed clamp mounting with hexagon socket head screws
- For left hand and right hand use

Material: Stainless Steel

Finish	Item No.
matt	981.00.000

Supplied With

Adapter plate for 10 mm (13/32") thick glass
Hex key

Note

A floor mounted door closer or bottom pivot bearing must be ordered separately for mounting the glass door.

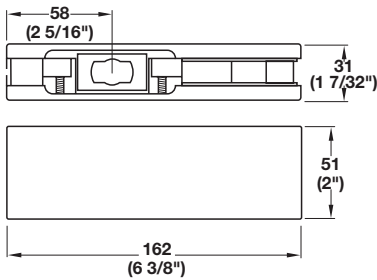

Glass preparation

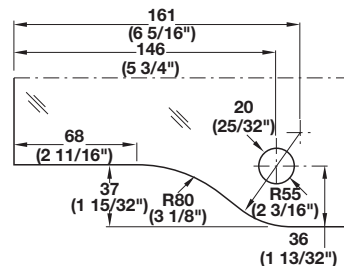

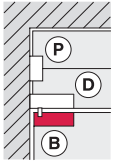

Top Door Patch Fitting ②

- For glass thickness 10-12.7 mm (13/32"-1/2")
- With plastic pivot insert for bolt Ø15 mm (Ø19/32")
- Load capacity: ≤ 80 kg (176 lbs.)
- Door width: ≤ 1.1 m (43 5/16")
- Concealed clamp mounting with hexagon socket head screws
- For left hand and right hand use

Material: Stainless Steel

Finish	Item No.
matt	981.00.010

Supplied With

Adapter plate for 10 mm (13/32") thick glass
Hex key

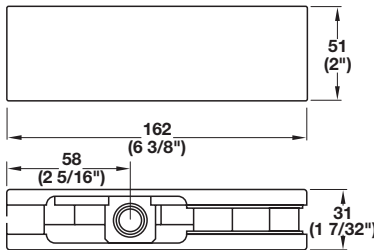

Glass preparation

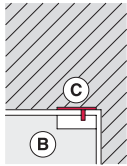
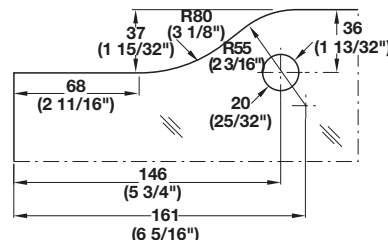

Top Pivot ③

- Surface mounted top pivot for top door patch fitting or top door rail
- Screw-mounted
- For left hand and right hand use

Material: Stainless Steel

Finish	Item No.
matt	981.00.080

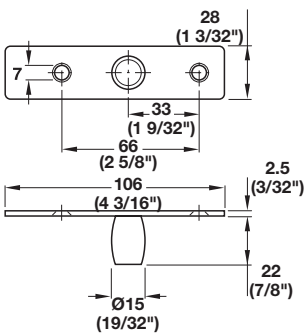

Dimensional data not binding. We reserve the right to alter specifications without notice.

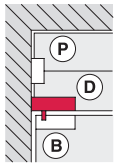

Transom Door Patch Fitting with Pivot (D)

- Counter bearing for top door patch fitting
- For glass thickness 10-12.7 mm (13/32"-1/2")
- M8 threaded hole at rear for wall mounting
- Concealed clamp mounting with hexagon socket head screws
- Bolt can be adjusted laterally by ±3 mm (1/8")
- For left hand and right hand use

Material: Stainless Steel

Finish	Item No.
matt	981.00.020

Supplied With

Adapter plate for 10 mm (13/32") thick glass
Mounting plate for wall mounting
Brass spreading dowel with M8 threaded bolt
Hex key

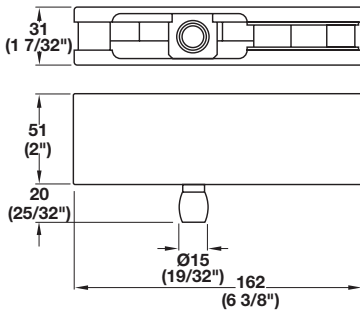

Glass preparation

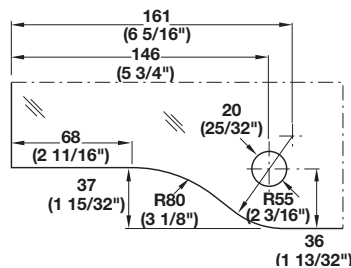

7

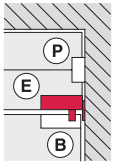

Transom Door Patch Fitting with Pivot (E)

- Counter bearing for top door patch fitting
- For glass thickness 10-12.7 mm (13/32"-1/2")
- Mounting plate at rear for wall mounting
- Concealed clamp mounting with hexagon socket head screws
- Bolt can be adjusted laterally by ±3 mm (1/8")
- For left hand and right hand use

Material: Stainless Steel

Finish	Item No.
matt	981.00.110

Supplied With

Adapter plate for 10 mm (13/32") thick glass
Screw-on plate
Set of mounting material
Hex key

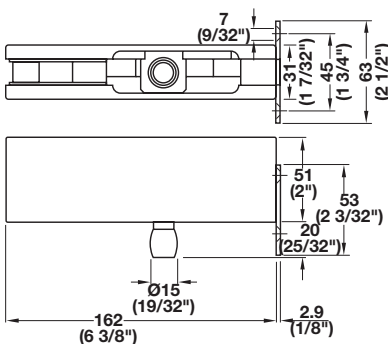

Glass preparation

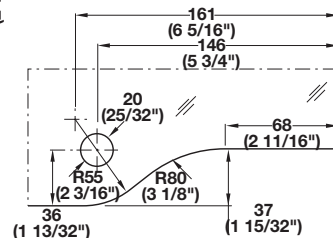

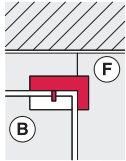

Sidelite/Transom Door Patch Fitting (F)

- Counter bearing for top door patch fitting
- For glass thickness 10-12.7 mm (13/32"-1/2")
- Concealed clamp mounting with hexagon socket head screws
- Bolt can be adjusted laterally by ±3 mm (1/8")
- For left hand and right hand use

Material: Stainless Steel

Finish	Item No.
matt	981.00.030

Supplied With

Adapter plate for 10 mm (13/32") thick glass
Hex key

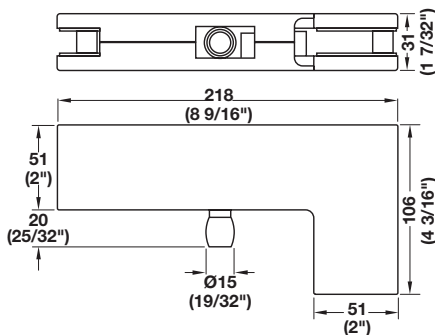

Glass Preparation

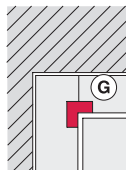
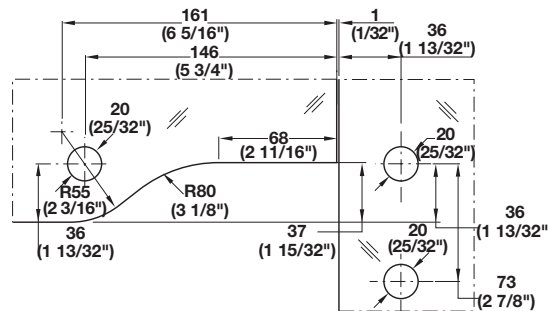

Sidelite/Transom Connection Patch Fitting (G)

- For single doors
- For glass thickness 10-12.7 mm (13/32"-1/2")
- Concealed clamp mounting with hexagon socket head screws
- Bolt can be adjusted laterally by ±3 mm (1/8")
- For left hand and right hand use

Material: Stainless Steel

Finish	Item No.
matt	981.00.060

Supplied With

Mounting insert
2 Dummy inserts for double acting doors
Adapter plate for 10 mm (13/32") thick glass
Hex key

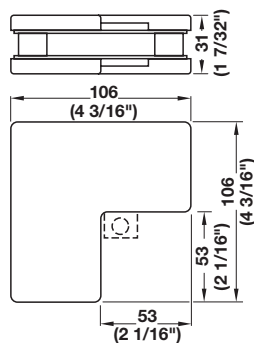

Glass preparation

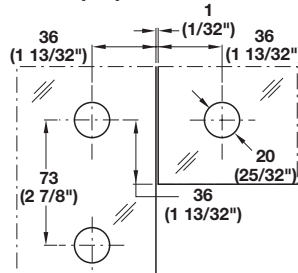

Dimensional data not binding. We reserve the right to alter specifications without notice.

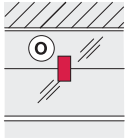

Connector Patch Fitting **O**

- For connecting 2 glass panes
- For glass thickness 10-12.7 mm (13/32"-1/2")
- Concealed clamp mounting with hexagon socket head screws

Material: Stainless Steel

Finish	Item No.
matt	981.00.130

Supplied With

Adapter plate for 10 mm (13/32") thick glass
Hex key

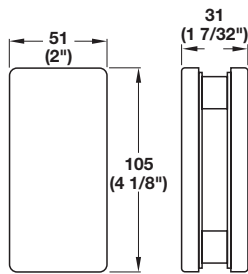

Glass preparation

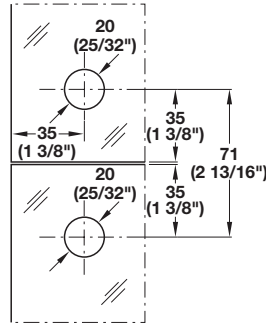

7

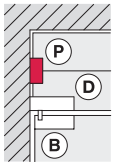

Connector Patch Fitting **P**

- For connecting 2 glass panes with glass to wall connection
- For glass thickness 10-12.7 mm (13/32"-1/2")
- Concealed clamp mounting with hexagon socket head screws

Material: Stainless Steel

Finish	Item No.
matt	981.00.140

Supplied With

Adapter plate for 10 mm (13/32") thick glass
Brass spreading dowel with M8 threaded bolt
Hex key

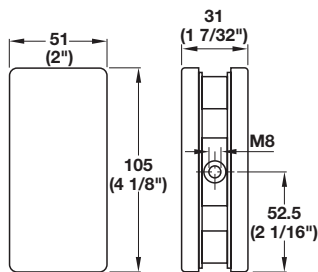

Glass preparation

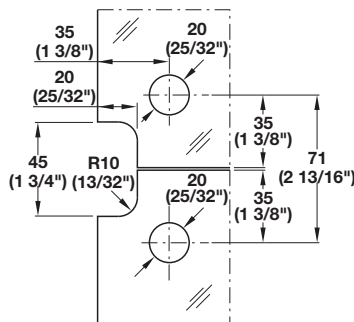

Dimensions in mm
Inches are approximate

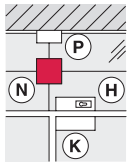

Connector Patch Fitting **(N)**

- For connecting 2-4 glass panes
- For glass thickness 10-12.7 mm (13/32"-1/2")
- Concealed clamp mounting with hexagon socket head screws

Material: Stainless Steel

Finish	Item No.
matt	981.00.120

Supplied With

Adapter plate for 10 mm (13/32") thick glass
Hex key

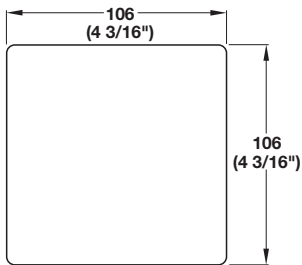
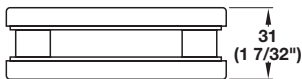

Glass preparation

(example shows the connection of 4 glass panes)

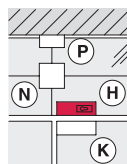
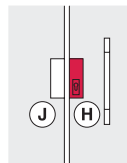
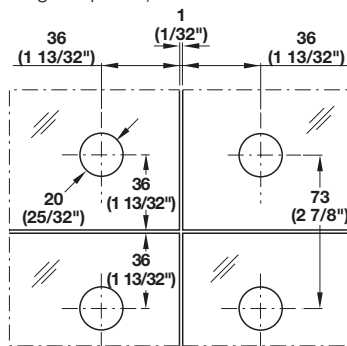

Center Door Patch Lock **(H)**

- For Euro profile cylinder
- For glass thickness 10-12.7 mm (13/32"-1/2")
- Deadbolt: 1 turn
- Concealed clamp mounting with hexagon socket head screws
- For left hand and right hand use

Material: Stainless Steel

Finish	Item No.
matt	981.00.410

Supplied With

Adapter plate for 10 mm (13/32") thick glass
Hex key
Mounting screw for Euro profile cylinder

Note

For Euro profile cylinder, contact Häfele.

Glass preparation

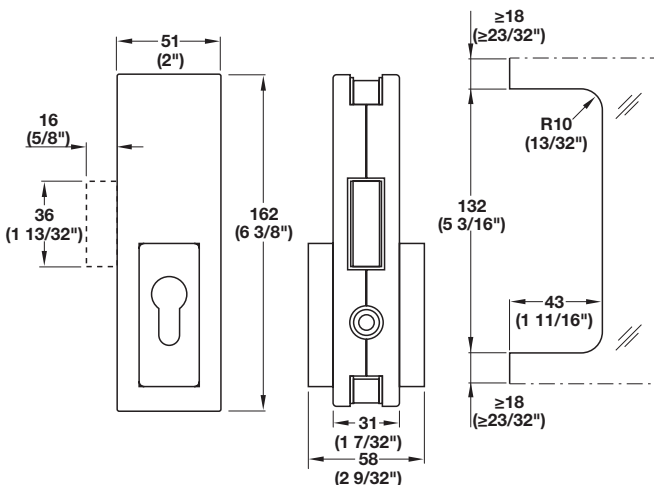

Dimensional data not binding. We reserve the right to alter specifications without notice.

Dimensions in mm
Inches are approximate

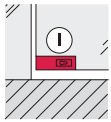

Corner Door Patch Lock ①

- For Euro profile cylinder
- For glass thickness 10-12.7 mm (13/32"-1/2")
- Deadbolt: 1 turn
- Concealed clamp mounting with hexagon socket head screws
- For left hand and right hand use

Material: Stainless Steel

Finish	Item No.
matt	981.00.400

Supplied With

Adapter plate for 10 mm (13/32") thick glass
Striking plate with mounting material
Mounting screw for profile cylinder
Hex key

Note

For Euro profile cylinder, contact Häfele.

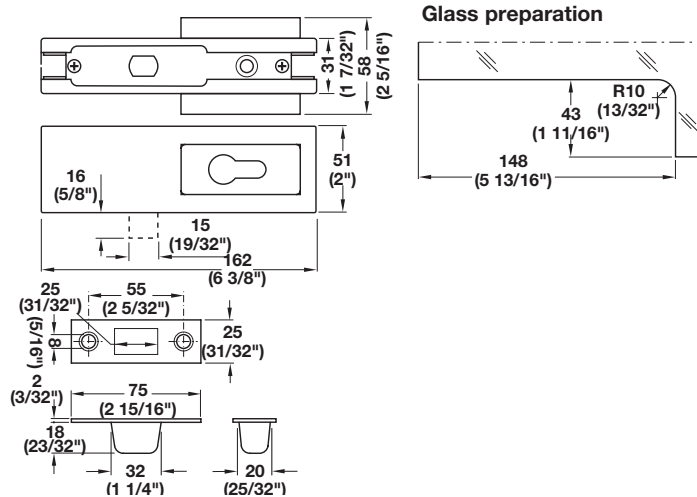

7

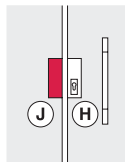

Center Door Patch Strike ②

- For glass thickness 10-12.7 mm (13/32"-1/2")
- Concealed clamp mounting with hexagon socket head screws
- For left hand and right hand use

Material: Stainless Steel

Finish	Item No.
matt	981.00.420

Supplied With

Adapter plate for 10 mm (13/32") thick glass
Hex key

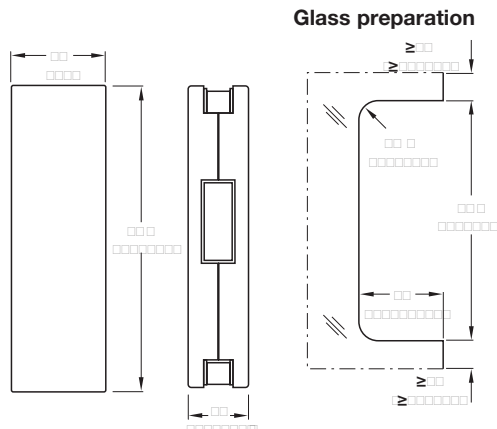

Dimensions in mm
Inches are approximate

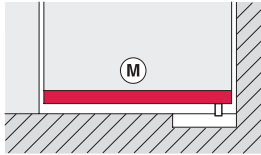

Bottom Door Rail (M)

- For Euro profile cylinder
- For glass thickness 10-12.7 mm (13/32"-1/2")
- With insert for flat conical floor door closer spindle
- Load capacity: ≤ 80 kg (176 lbs.)
- Door width: ≤ 1.0 m (39 3/8")
- Deadbolt: 1 turn
- Clamp mounting with plastic profiles and silicon joints
- Door rails can be shortened
- For left hand and right hand use

Material: Stainless Steel

Finish	Item No.
matt	981.00.200

Supplied With

Plastic profiles for 10 and 12.7 mm (13/32"-1/2") glass
 2 End caps
 Strike plate with mounting material
 Mounting screw for Euro profile cylinder

Note

A floor mounted floor door closer must be ordered separately. For Euro profile cylinder and door closer, contact Häfele.

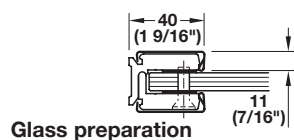
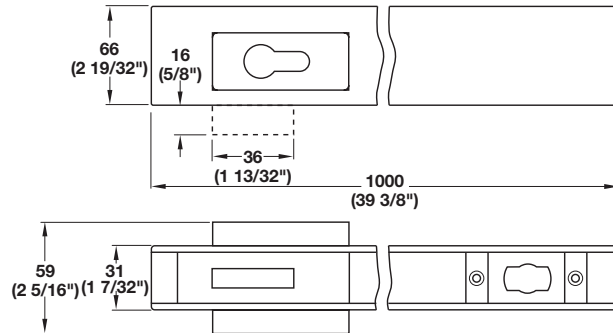
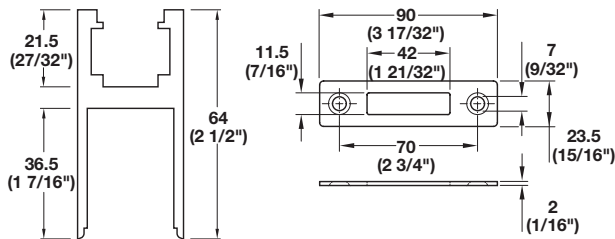

Glass preparation

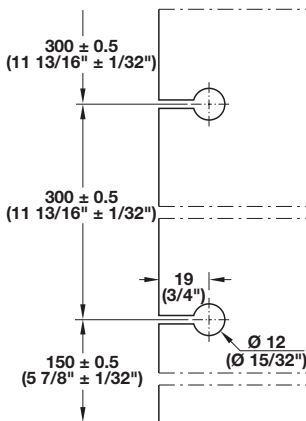

Wall and Ceiling Clamping Profile (Q)

- For wall and/or ceiling mounting of sidelites and transoms
- For glass thickness 10-12.7 mm (13/32"-1/2")
- Invisible clamp mounting with hexagon socket head screws
- Clamp mounting height every 300 mm (11 13/16")
- Length: 3.0 m (9' 10 1/8")

Material: Stainless Steel

Finish	Item No.
matt	981.35.210

Supplied With

2 Stainless Steel covers

Dimensional data not binding. We reserve the right to alter specifications without notice.

Dimensions in mm
Inches are approximate

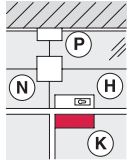

Top Door Patch Strike (K)

- For glass thickness 10-12.7 mm (13/32"-1/2")
- M8 threaded hole at rear for wall mounting
- Concealed clamp mounting with hexagon socket head screws
- For left hand and right hand use

Material: Stainless Steel

Finish	Item No.
matt	981.00.470

Supplied With

Adapter plate for 10 mm (13/32") thick glass
Brass spreading dowel with M8 threaded bolt
Hex key

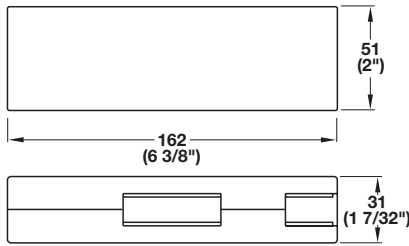

Glass preparation

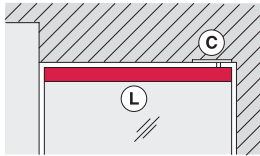
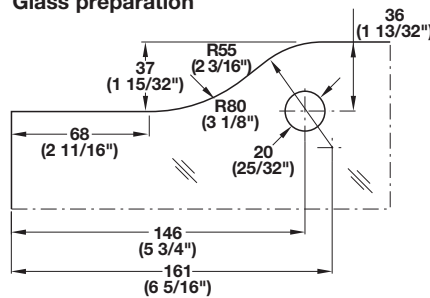

Top Door Rail (L)

- For glass thickness 10-12.7 mm (13/32"-1/2")
- With plastic pivot insert for bolt Ø15 mm (Ø19/32")
- Load capacity: ≤ 80 kg (176 lbs.)
- Door width: ≤ 1.0 m (39 3/8")
- Clamp mounting with plastic profiles and silicon joints
- Door rail can be shortened
- Adjusting facility: Pivot insert can be adjusted laterally by ±5 mm (±3/16")
- For left hand and right hand use

Material: Stainless Steel

Finish	Item No.
matt	981.00.252

Supplied With

Set of plastic profiles for 10 and 12.7 mm (13/32"-1/2") thick glass
2 End caps

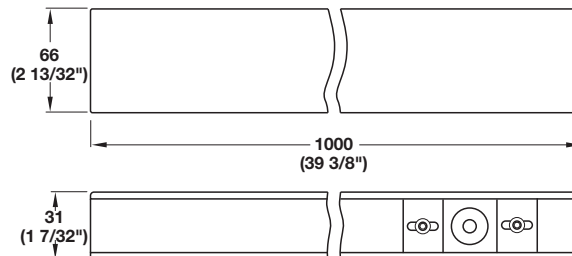
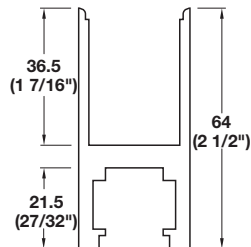

Item No. **Page No.**

981.00.000 7.4
981.00.010 7.5
981.00.020 7.6
981.00.030 7.7
981.00.060 7.7
981.00.080 7.5
981.00.110 7.6
981.00.120 7.9
981.00.130 7.8
981.00.140 7.8
981.00.200 7.11
981.00.252 7.12
981.00.400 7.10
981.00.410 7.9
981.00.420 7.10
981.00.470 7.12
981.35.210 7.11

Important <https://HardwareShowroom.com>

This catalog is intended for exclusive use by the recipient. No part of this publication may be distributed in any form to direct competitors of Häfele. Häfele retains complete ownership of this catalog.

Häfele reserves the right to demand the return of this catalog in any case where it is employed for purposes of unfair competition.

Reproduction of this catalog, either wholly or in part, or reprinting of any drawing or copying of the layout, are strictly forbidden.

The technical data and dimensions contained in the drawings are nonbinding and are subject to design improvement.

Häfele accepts no liability for any typographical or other type of error which may occur in the production of this catalog.

All merchandise is furnished subject to Häfele's official Terms and Conditions of Sale.

*January, 2015
© 2015 Häfele America Co.
All rights reserved.
Printed in USA.*